

95mm

125mm

JetFresh

UVC Toothbrush Sanitizer

User Manual

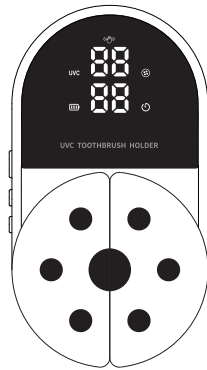

Safety instructions:

1. Please read the instructions carefully before using.
2. For children, use under adult supervision.
3. Strong ultraviolet rays are harmful to eyes and skin. It is strictly prohibited to look directly at the UV module or be exposed to the UV module under the working condition for a long time.
4. The product contains electronic components; do not submerge it in water for cleaning. The surface can be wiped with a damp cloth.
5. The product has a rechargeable battery inside. Do not expose it to water, fire, or high-temperature environments. Dispose of the product in accordance with local laws and regulations.

Instruction

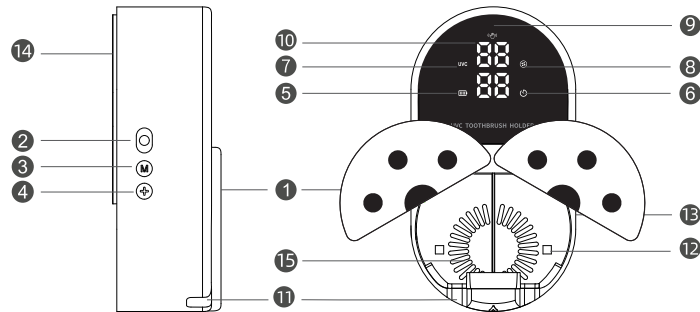

- 1 Front Cover: Automatically open/close via hand-wave or multi-function button.
- 2 Power Button : Turn the device on and off, and initiate or terminate the disinfection program.
- 3 Clock Set Button : Switch to the clock setting interface.
- 4 Multi-function Button :
 - Adjust the clock's hours and minutes.
 - Open or close the cover.
 - Turn automatic disinfection mode on or off.
- 5 Battery Indicator Light : Indicate battery status or charging status.
 - Flashing red light: Low battery level, charging needed.
 - Steady red light: Charging.
 - Steady green light: Battery fully charged.
- 6 Working Indicator Light : When the device runs the disinfection program, the light stays on. When automatic disinfection mode is activated, this light flashes every 5 seconds while in standby.
- 7 UV Indicator Light : When UV LED is working, the light stays on.
- 8 Fan Indicator Light : When the fan is working, the light stays on.

- 9 Sensing Area: Detect hand-wave motions near the device. Do not cover or paint this component to prevent malfunctions.
- 10 Display Screen: Display the current system time and working status.
- 11 Toothbrush Stand: Secure toothbrushes.
- 12 UV LED : Disinfect items inside the device.
- 13 Type-C Charging Port: Connect with a Type-C charging cable and a DC 5V adapter for charging.
- 14 Mounting board: Stick to a surface to install and secure the device.
- 15 Fan: Accelerates air circulation in the device.

Installation

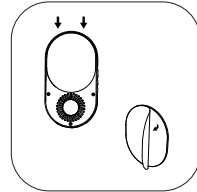

1. Clean and dry the surface where the mounting board will be pasted. Remove the protective film from the adhesive tape on the back of the mounting board.

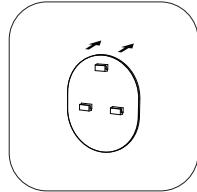
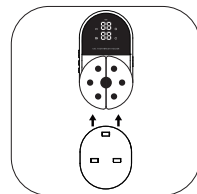

2. Stick the mounting board on the clean surface in the correct direction and press firmly to ensure complete adhesion.

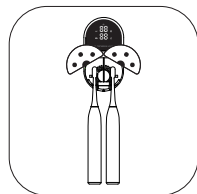

3. After 24 hours, install the main unit on the mounting board, ensuring that it is secured properly.

4. Hang the toothbrush on the device and then use its functions.

How to use

Before using the product, shake off excess water from the toothbrush to ensure it is as dry as possible.

Turn On and Off

Long press button ② for 3 seconds to turn the device on or off.

- When turning on, the screen will display a boot-up animation and then show the time.
- When turning off, the screen will display a shutdown animation.

Cover Opening & Closing

Wave Sensing Mode

When the cover is closed, wave your hand in front of the sensing area to open it. Wave again to close the cover.

Button Mode

Press button ④ to open/close the cover.

Attention

The cover will automatically close 3 minutes after opening. Do not open/close the cover directly by hand contact. Do not apply force to stop the cover during movement to avoid damage.

Clock

Clock Adjustment

Press button ③ to enter the clock setting interface. The hour digits will flash. Press button ③ again to switch to minutes, and the minute digits will flash. Use button ④ to adjust the hours and minutes while they are flashing. After completing the

adjustments, remember to press button ③ again to save the set time. The clock setting interface will automatically exit if no button is pressed within 15 seconds.

Attention

The clock has a memory function. When using the clock for the first time, it needs to be set to the correct time. If the battery is completely depleted, the clock will need to be reset.

Disinfection

Manual Disinfection Mode

- Wave to close the cover, or press button ② to start.
- When the program is running, the screen displays a 5-minute countdown, with UV led and the fan operating throughout.

Automatic Disinfection Mode

- The mode is enabled automatically when the device is turned on. The device automatically initiates disinfection at 06:00, 07:00, 20:00, and 21:00 (based on system time).
- When the program is running, the screen displays a 1-minute countdown, with UV led and the fan operating throughout.
- To turn it off, long press button ④ until the display shows "AOFF". To turn it on again, long press the same button until the display shows "AUTO". The mode will automatically turn off when the battery is low.

Attention

When the program is running, waving to open the cover or pressing button ②/④ will terminate the current program without canceling automatic disinfection mode.

Cleaning and Maintenance

1. The toothbrush stand can be removed and submerged in water for cleaning. Ensure it is completely dry before reattaching. Other parts of the product can be

wiped with a dry cloth dampened with a little water or cleaner.

2. Do not cover the product in working status. Maintain a dry working environment to prevent water ingress or prolonged exposure to humidity.

3. To ensure electrical safety, please use the original charging cable and a compatible adapter for power supply. When the battery is fully charged, please disconnect the adapter in a timely manner.

Specification

Model: ES X9

Material: ABS+PC

Battery: 3.7V, 2000mAh, rechargeable battery

Power input: DC 5V 1A, USB Type-C

Power consumption: 5W (maximum)

Operating temperature: 32 °F ~ 113 °F

Size: 135 * 73 * 49 mm

Weight: 215g

Package content: sanitizer*1, 1A Type-C charging cable *1, user manual *1

Warranty

If you need aftersales service, please contact the sales channel or our aftersales customer service in time. For specific operations, please fill out this user information card and send it back with the product.

Name: _____ Phone: _____

Address: _____

Purchase date: _____

Order number: _____

Dealer name: _____

Fault description: _____

